

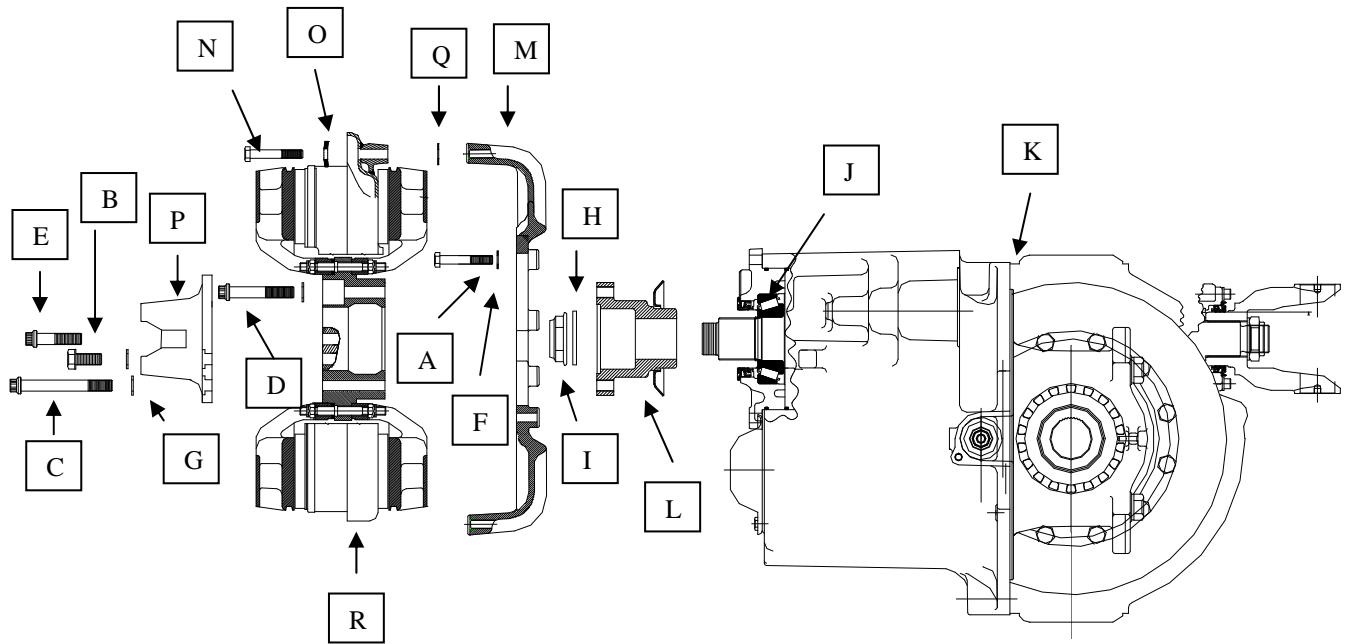

## Telma / Meritor Tandem Part Number Cross Reference



Item	Qty	Telma Part Number	Meritor Part Number	Description
A	7	TIF04105	MS-212075-B-2	M12x1.75x75mm Hex Head Cap Screw
B	2	TIF04046	SP-11012-B-2	5/8-18 UNF x 1.5" Hex Head Cap Screw
C	4	TIF04083	SP2012	5/8-18UNF x 5" 12PT. Cap Screw
D	4	TIF04075	SP1047	5/8-18UNF x 3.5" 12PT. Cap Screw
E	2	TIF04045	SP-1000	5/8-18UNF x 2.5" 12PT. Cap Screw
F	7	N/A	1229-C-1511	0.88x0.53x0.09 Bearing Cage Washers
G	10	TIF04030	1229-U-1503	1.06x.66x.09 Washers
H	1	N/A	1229N1730	3x1.79x.19 Input Shaft Washer
I	1	N/A	40X1233	Input Shaft Nut
J	1	N/A	A1 1205x2728	Input Shaft Seal & Sleeve
K	15	N/A	1229B4786	Nord Lock Washers
*L	1	N/A	A-3260-E-1877	RD/RP160 Companion Flange
*L	1	N/A	A-3260-K-1883	RD145 Companion Flange
*L	1	N/A	A-3260-L-1884	RP145 Companion Flange
M	1	VB515697	A-3280-G-9861	Stator Bracket
N	8	VF100615	41x-1356	M12x1.75x75mm Stator Bolts (Plated)
O	8	VF201400	1229-C-4449	12.5x26x4 Trep Washers
*P	1	VB107149	3260-S-1501	1710 Series Flange Yoke
*P	1	VB107793	3260-J-1882	1760 Series Flange Yoke
*P	1	VB107148	3260-R-1500	1810 Series Flange Yoke
Q	1	VB200330	2803-U-2751	Stator Shim Kit
**R	1	DK311387	A-3280-F-9860	Telma Focal Model FN72-40 (Meritor Tandem)

\* Only (1) required per assembly

\*\* Includes assembled retarder with rotors and item Q (shim kit)

**For DK311387 Spare Parts refer to document OC443001**

This document is the exclusive property of TELMA RETARDER INC. It cannot be copied, modified, forwarded, or given to any third party without prior agreement from TELMA RETARDER INC. Any infringement will immediately involve legal action.